

PART REV	DWG ISSUE	DATE	ECN NO.	APPVD BY	REL BY
-	-	9/2/16	UMI6079	DW	DW

F  
E  
D  
C  
B  
A

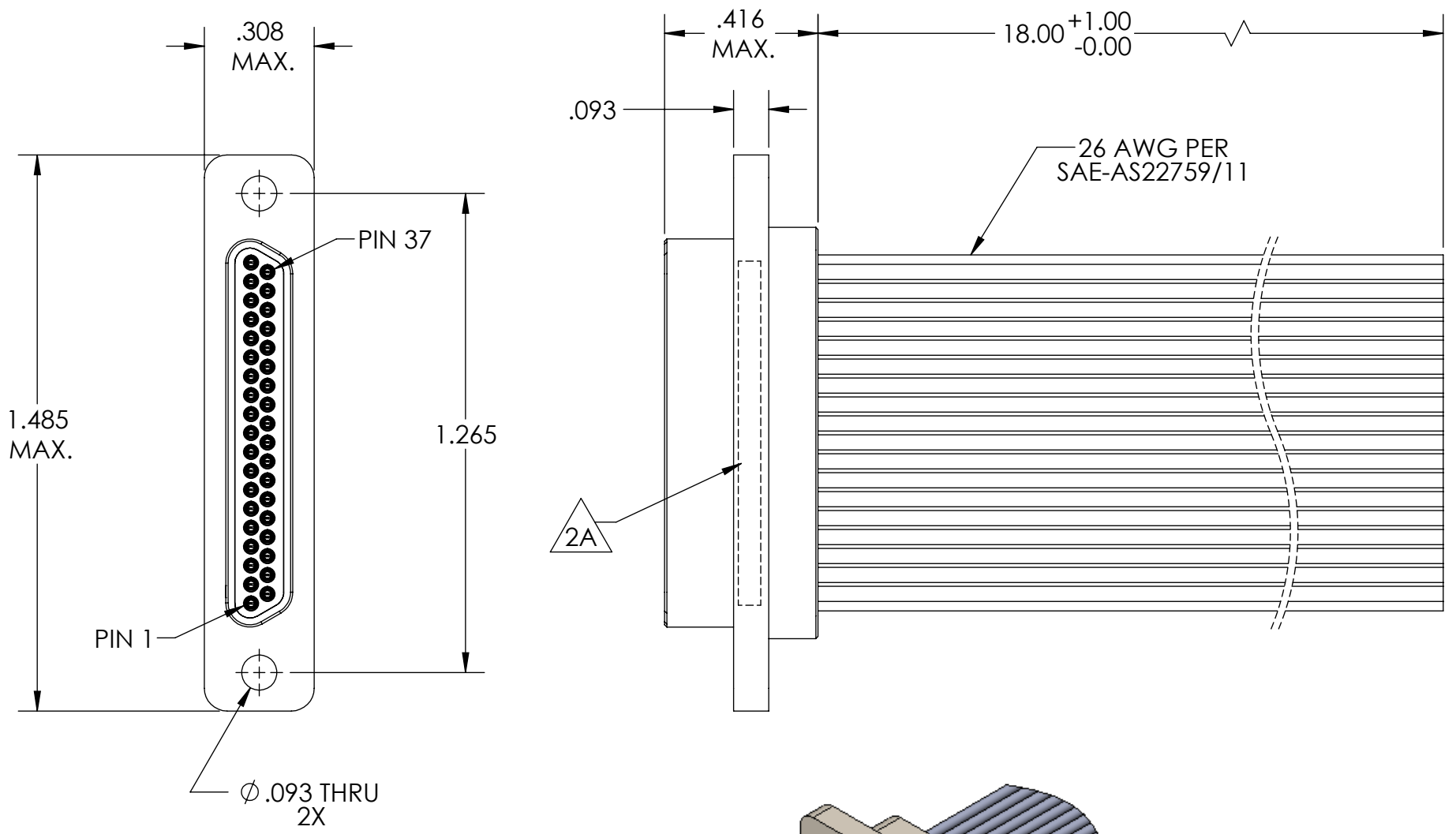

1	BLK	20	WHT
2	BRN	21	BLK
3	RED	22	BRN
4	ORG	23	RED
5	YEL	24	ORG
6	GRN	25	YEL
7	BLU	26	GRN
8	VIO	27	BLU
9	GRY	28	VIO
10	WHT	29	GRY
11	BLK	30	WHT
12	BRN	31	BLK
13	RED	32	BRN
14	ORG	33	RED
15	YEL	34	ORG
16	GRN	35	YEL
17	BLU	36	GRN
18	VIO	37	BLU
19	GRY		

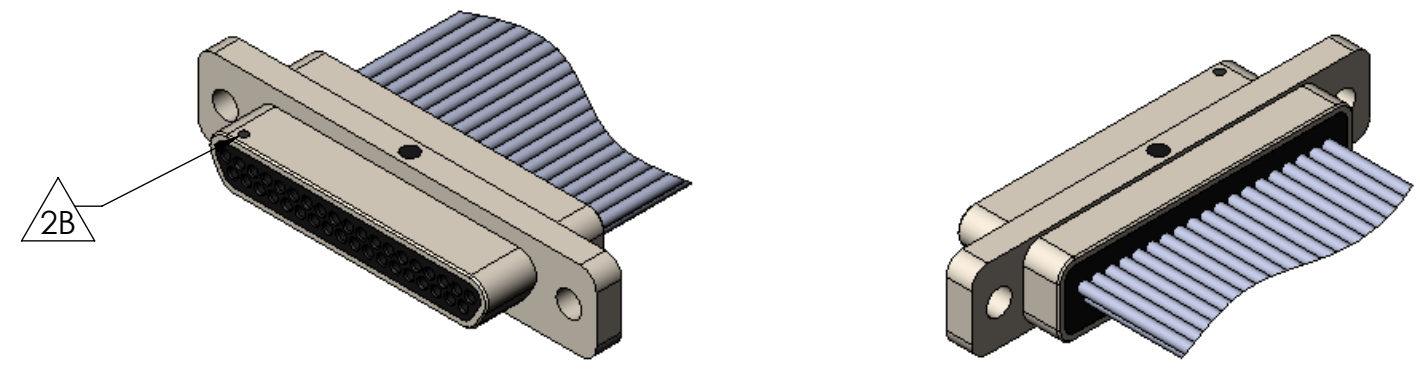

4. PERFORMANCE SPECIFICATIONS:  
 CURRENT RATING: 3 AMPS MAX.  
 INSULATION RESISTANCE: 5000 MEGOHMS MIN.  
 DWV: 600 VAC  
 TEMPERATURE RATING: 125° C

3 MATERIALS:  
 SHELL: 6061-T6 ALUMINUM PER AMS-QQ-A200/8, NICKEL PLATED PER AMS-2404  
 INSULATOR: PPS PER MIL-M-24519 GST-40F, COLOR: BLACK  
 PIN CONTACTS: C17200 BERYLLIUM COPPER PER ASTM B194, GOLD PLATED PER ASTM B488  
 WIRE: 26 AWG PER SAE-AS27759/11-26, COLOR CODE: REPEATING 10 COLORS PER MIL-STD-681

2. MARKING:  
 2A "UMI", DATE CODE, M83513/03-F03N, AND WORK ORDER NUMBER  
 2B A DOT INDICATING POSITION 1

1. CONNECTOR ASSEMBLY IS IAW MIL-DTL-83513 UNLESS OTHERWISE SPECIFIED.  
**NOTES: UNLESS OTHERWISE SPECIFIED.**

QUALITY SYMBOLS CRITICAL C MAJOR NO SYMBOLS = MINOR DIMENSIONS	UNLESS OTHERWISE SPECIFIED: ALL DIMENSIONS ARE IN INCHES	SCALE NONE	DWG SIZE B	THIRD ANGLE PROJECTION	REVISE ON CAD ONLY	
	GENERAL TOLERANCES: 3 PLACES ±.005 2 PLACES ±.01 ANGULAR ±2°	DRAWN BY & DATE DU 9/2/16	TITLE: MICRO-D CONNECTOR ASSEMBLY, MIL-DTL-83513/03-F03N, MR37PO-26M6-18.00, NICKEL PLT SHELL		MATERIAL: 3	ENG PROJECT #: NONE
	ULTI-MATE CAGE CODE 58967	CHECKED BY & DATE DW 9/2/16	PART NO. 835161030		DRAWING NO. SD-835161030	SHEET NO. 1 of 1
		APPROVED BY & DATE DW 9/2/16	CAD FILE NAME SD-835161030.SLDDRW		THIS DRAWING CONTAINS INFORMATION THAT IS PROPRIETARY TO ULTI-MATE INCORPORATED AND SHOULD NOT BE USED WITHOUT WRITTEN PERMISSION.	

