

PART/DWG REV ISSUE	DATE	ECN NO.	APPD BY	REL BY
-	02/17/11	UM4305	TPOWERART	PER

WIRING COLOR CODE

1, 11, 21	BLACK
2, 12	BROWN
3, 13	RED
4, 14	ORANGE
5, 15	YELLOW
6, 16	GREEN
7, 17	BLUE
8, 18	VIOLET
9, 19	GRAY
10, 20	WHITE

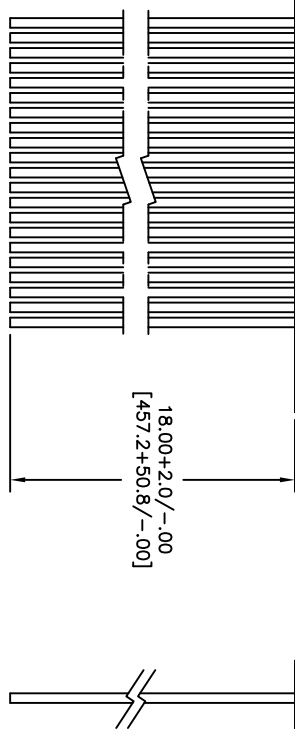
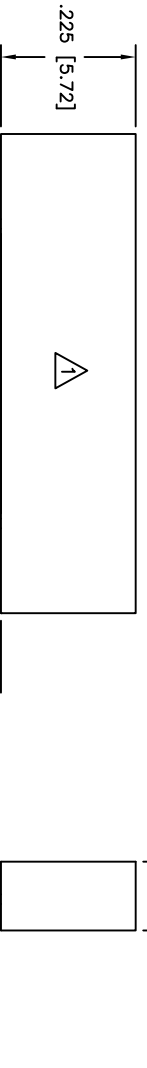
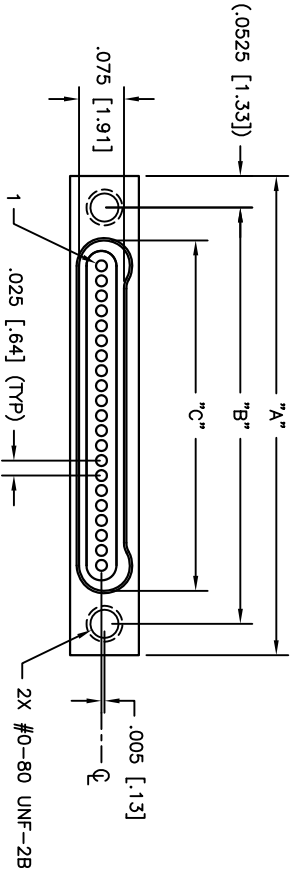

3. PERFORMANCE: MEETS OR EXCEEDS M32139 PERFORMANCE SPECIFICATIONS

- CONTACT RATING: 1 AMPERE MAXIMUM
- DMV: 250 VAC
- INSULATION RESISTANCE: 5000 MEGOHMS MINIMUM @ 100 VDC
- CONTACT RESISTANCE: 0.071 VOLT MAXIMUM DROP @ 1.0 AMPS (.071 OHMS) W/6.00" OF WIRE LISTED BELOW, PER MIL-DTL-32139

2. MATERIALS:

- SHELL: ALUMINUM 6061-T6, ELECTROLESS NICKEL PLATED PER AWS2404
- INSULATOR: LCP (LIQUID CRYSTAL POLYMER) GLCP-30F
- CONTACT: BRASS ALLOY 735, GOLD PLATED PER ASTM B488
- LEADS: 30 AWG, NEMA HP3, TYPE ET, COLOR CODED PER MIL-DTL-681, SYSTEM 1, EXCEPT USING 10 SOLID REPEATING COLORS

MARKINGS: UMI, DATE CODE, UMI P/N AS SPACE PERMITS OTHERWISE ON BAG OR TAG  
NOTES: UNLESS OTHERWISE SPECIFIED

PART NO.	SIZE	"A"	"B"	"C"
833211627	9	5.00 [12.70]	.395 [10.03]	.285 [7.24]
833221627	15	.650 [16.51]	.545 [13.84]	.435 [11.05]
833231627	21	8.00 [20.32]	.695 [17.65]	.585 [14.86]
833241627	25	.900 [22.86]	.795 [20.19]	.685 [17.40]
833251627	31	1.050 [26.67]	.945 [24.00]	.835 [21.21]
833261627	37	1.200 [30.48]	1.095 [27.81]	.985 [25.02]
833271627	51	1.550 [39.37]	1.445 [36.70]	1.335 [33.91]

SCALE 5:1	DWG SIZE B	THIRD ANGLE PROJECTION	REVISE DN CAD ONLY
DRAWN BY & DATE UMI 03-09-10	CHECKED BY & DATE	TITLE: NANO-D SINGLE ROW CONNECTOR	
SEE ECN	APPROVED BY & DATE	FEMALE, SIZE XX, NMLXX-1507-30F6-18.0 S01	
SEE ECN		MATERIAL: UMI-Mate Connector Inc.	
CAD FILENAME SD-833231627.DWG	PART NO. SD-833231627	DRAWING NO. SD-833231627	SHEET NO. 1 OF 1
THIS DRAWING CONTAINS INFORMATION THAT IS PROPRIETARY TO ULTI-MATE		REV	
INCORPORATED AND SHOULD NOT BE USED WITHOUT WRITTEN PERMISSION			

A

B

C

D

E

F