

PART DWG	DATE	ECN NO.	APPD BY	REL BY
REV ISSUE				
A	07/08/19	UMI7201	T-POWBAR	PER

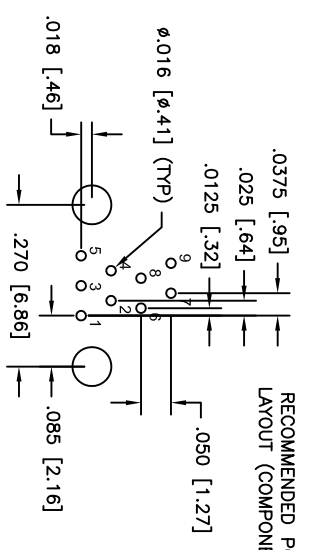
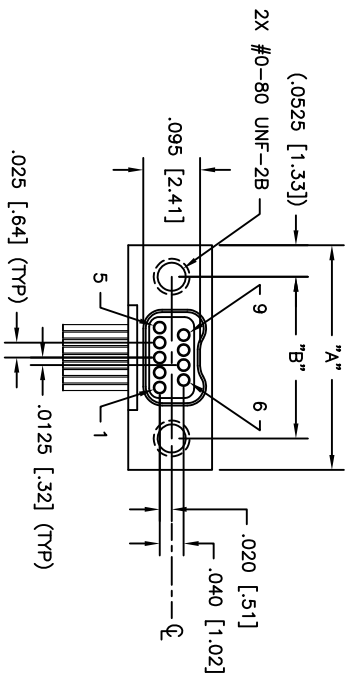
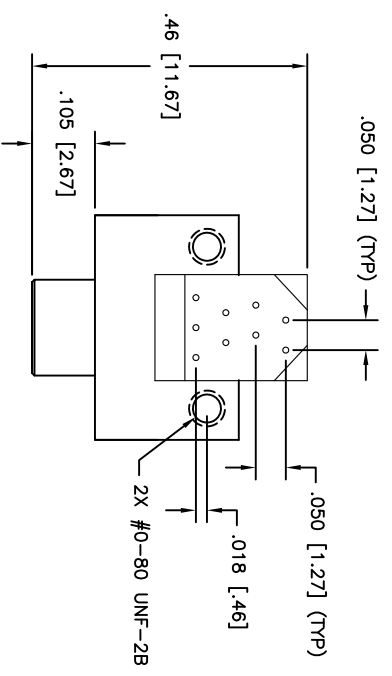
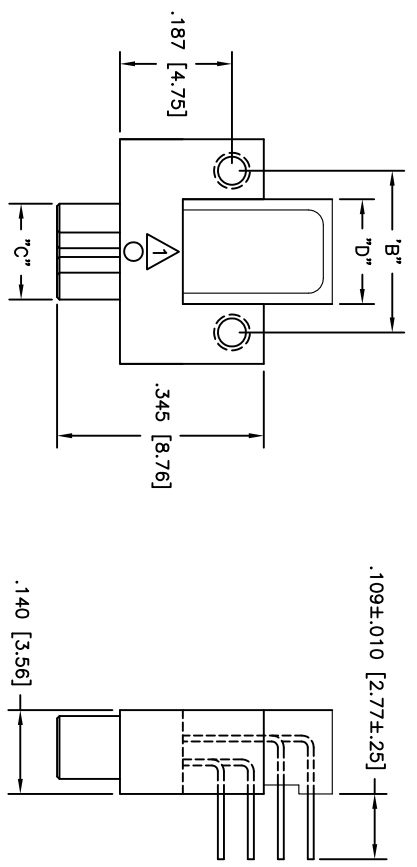

3. PERFORMANCE: MEETS OR EXCEEDS M32139 PERFORMANCE SPECIFICATIONS
 CONTACT RATING: 1 AMPERE MAXIMUM
 DMV: 250 VAC
 INSULATION RESISTANCE: 5000 VOLT MEGOHMS MINIMUM @ 100 VDC
 CONTACT RESISTANCE: 0.021 VOLT MAXIMUM DROP @ 1.0 AMPS (.021 OHMS)

MATERIALS: SHELL: ALUMINUM 6061-T6, ELECTROLESS NICKEL PLATED PER AMS2404
 INSULATOR: LCP (LIQUID CRYSTAL POLYMER) GLCP-30F
 CONTACT: BERYLLIUM COPPER PER ASTM B194, GOLD PLATED PER ASTM B488
 BACKSHELL: PPS PER MIL-M-24519 GST-40F
 LEADS: 30 AWG (Ø .010) GOLD PLATED

MARKINGS: UMI, UMI P/N, DATE CODE & W/O NO. AS SPACE PERMITS OTHERWISE ON BAG OR TAG
 NOTES: UNLESS OTHERWISE SPECIFIED

PART NO.	SIZE	"A"	"B"	"C"	"D"
832311827	9	.375 [9.52]	.270 [6.86]	.160 [4.06]	.175 [4.44]

QUALITY SYMBOLS	UNLESS SPECIFIED, ALL DIMENSIONS IN INCHES	SCALE	DWG SIZE	THIRD ANGLE PROJECTION	REVISE ON CAD ONLY
MAJOR =	GENERAL TOLERANCES:	5:1	B		
CRITICAL =	3 PLACE ±.005	DRAWN BY & DATE			
SPC =	2 PLACE ±.010	UMI 03-09-15			
	ANGULAR ±2°	CHECKED BY & DATE			
		APPROVED BY & DATE			
		CAD FILENAME	PART NO.	DRAWING NO.	SHEET NO.
		SD-832311827.DWG	832311827	SD-832311827	1 OF 1
		THIS DRAWING CONTAINS INFORMATION THAT IS PROPRIETARY TO ULTI-MATE			PART REV
		INCORPORATED AND SHOULD NOT BE USED WITHOUT WRITTEN PERMISSION			A